

KLEINES KAPPENSCHLOSS 30

MIT GERADER GRUNDPLATTE UND GEGENHAKEN

SMALL TOGGLE 30



WITH FLAT BASE PLATE AND HOOK

GRENOUILLÈRE PETIT MODÈLE 30

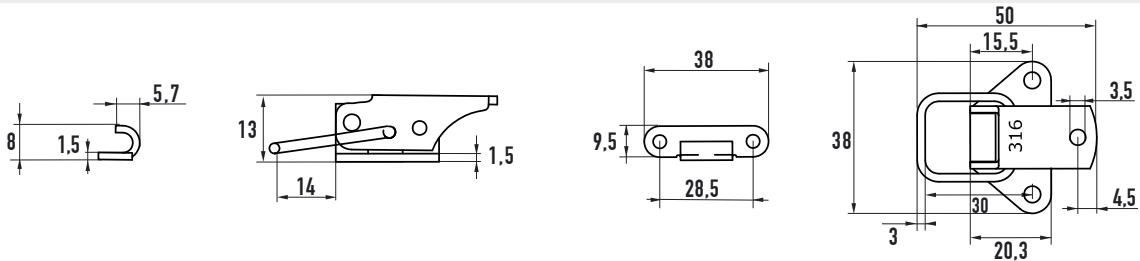

AVEC PATTE PLATE ET CROCHET

Nietloch / rivet hole / trou pour rivet \varnothing 3,8 mm



Stahl verzinkt
Steel zinc plated
Acier zingué

\varnothing		
3,8	100	55430 12300

Edelstahl A2 W.-Nr. 1.4301/03 AISI 304
Stainless steel A2 W.-Nr. 1.4301/03 AISI 304
Acier inox A2 W.-Nr. 1.4301/03 AISI 304

\varnothing		
3,8	100	55445 00130

Edelstahl A4 W.-Nr. 1.4401 AISI 316
Stainless steel A4 W.-Nr. 1.4401 AISI 316
Acier inox A4 W.-Nr. 1.4401 AISI 316

\varnothing		
3,8	100	55445 11300



Änderungen vorbehalten Subject to modifications Sous réserve de modifications